

### Conditions for Tests

Blum, Inc. does a great deal of testing to ensure that the quality of our hardware is consistent with the usual high standards that our customers have come to expect from Blum. For this reason we have rigorous testing procedures which are carried out from the development stage through production. Blum's internal testing standards are based on practical applications of our products and are more stringent than what is required by ANSI/BHMA.

**NOTE:** All Blum hinges meet or exceed ANSI/BHMA A156.9 Grade 2 requirements. All concealed hinges are designed for indoor use.

#### ISO 9001

Blum, Inc. is ISO 9001 certified which means that you are assured of consistent quality in every Blum product.

#### ANSI/BHMA

All Blum hinges meet or exceed ANSI/BHMA Grade 2 requirements. Contact your local Blum representative for more details.

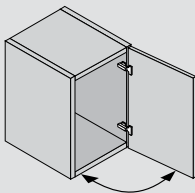
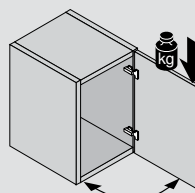

Cycle test	
<b>Specifications</b>	<ul style="list-style-type: none"> <li>Door size – 23-5/8" height, 23-5/8" width, 3/4" thickness</li> <li>Door weight –14.3 lb for cycle tests</li> <li>Door weight – 18.5 lb for load and over push tests</li> <li>Boring distance – 3 mm</li> </ul>
<b>Distance between hinges</b>	<ul style="list-style-type: none"> <li>16-15/16"</li> </ul>
<b>Hinge and mounting plate attachment</b>	<ul style="list-style-type: none"> <li>Hinges are mounted to test blocks and attached to test door and stand with clamps</li> <li>Test blocks for door: Particle board</li> <li>Test blocks for mounting plate: Wood</li> </ul>

Cycle test	
	<div> <b>Without load</b> <ul style="list-style-type: none"> <li>100,000 opening and closing for all COMPACT CLIP</li> </ul>  </div>
	<div> <b>With load</b> <ul style="list-style-type: none"> <li>11 lb extra weight is applied for 100,000 opening and closing cycles</li> </ul>  </div>
	<div> <b>Positive test result</b> </div>

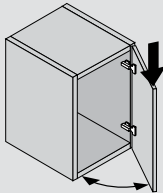
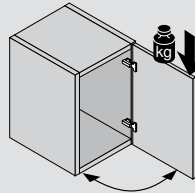
Load test	
	<div> <b>Static load</b> <ul style="list-style-type: none"> <li>67 lb applied ten times for five seconds, each at 45° opening angle</li> </ul>  </div>
	<div> <b>Dynamic load</b> <ul style="list-style-type: none"> <li>44 lb extra weight applied for fifty opening and closing cycles</li> </ul>  </div>
	<div> <b>Positive test result</b> </div>

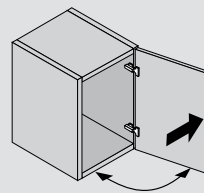
Over push test	
	<div> <b>Without load</b> <ul style="list-style-type: none"> <li>COMPACT CLIP hinges – Increasing forces up to 15 lb applied for a total of 40 times for five seconds each</li> </ul>  </div>
	<div> <b>Positive test result</b> </div>



### Screw-on

Use #6 wood screws.

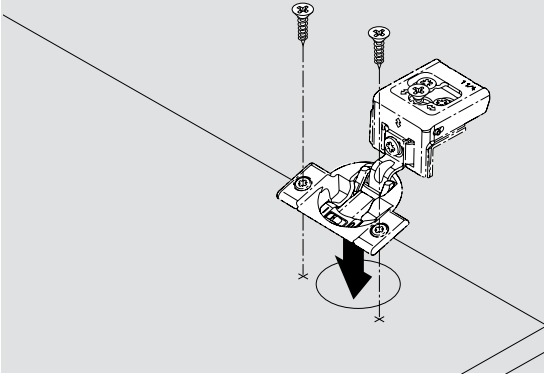

### Press-in

Pre-attached Ø8 dowels installed with Blum press-in tool or MINIPRESS with COMPACT insertion ram.

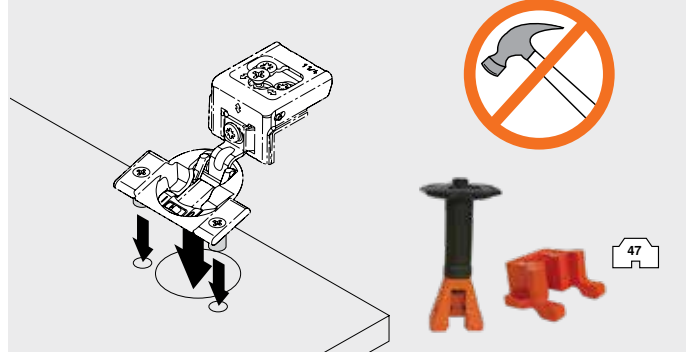

### Mounting plate attachment

#### 30C series – wraparound/edge mount

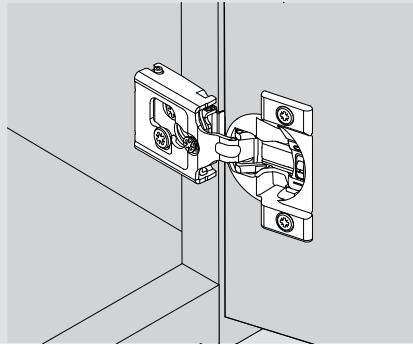

#### 31C series – wraparound

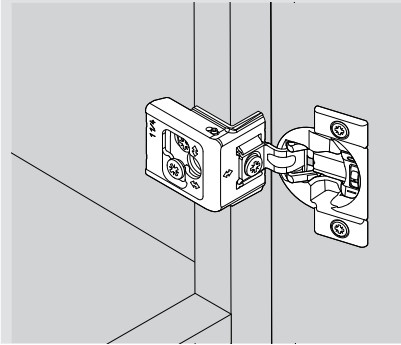

### Minimum reveal

A minimum reveal per door is required to keep the door from binding and varies depending on door thickness.

See minimum reveal table for each hinge.

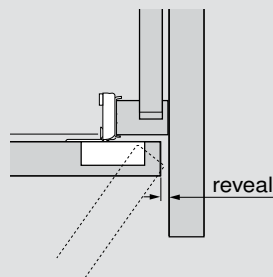

### Hinge cup centerpoint

Hinge cup centerpoint and MINIPRESS setback position is 20.5 (13/16") for COMPACT CLIP hinges.

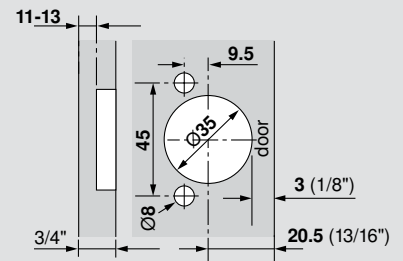

**NOTE:** Maximum door thickness 3/4"

### Hinges per door

This chart can serve as a guide for determining the number of hinges per door. Note that door weight can also determine the number of hinges required.

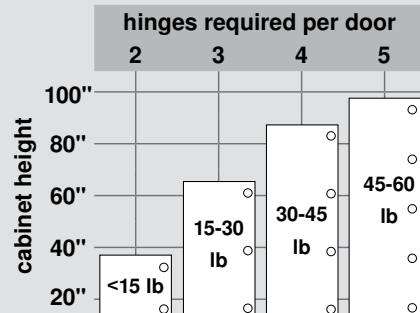

**NOTE:** The distance between the top and bottom hinges must be greater than the width of the door



### Clip features

With COMPACT CLIP, doors can be removed and reattached quickly and tool free. Not only does this save installers time on the jobsite, it also reduces the risk of damage to the cabinet frame.

### Hinge attachment

**Step 1:** Slide hinge onto CLIP plate until hinge clips in place.

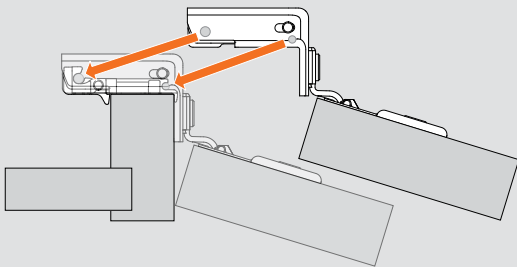

### Hinge removal

**Step 1:** Locate CLIP release lever on back of hinge(A) and press down to release(B).

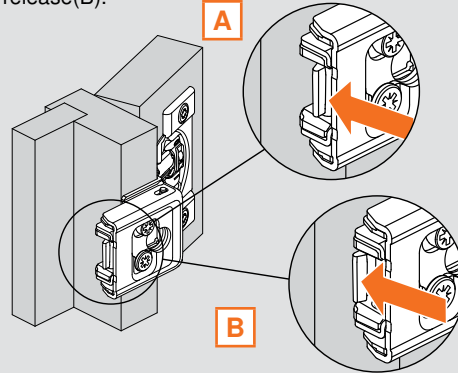

**Step 2:** While the CLIP lever is released, pull forward on hinge / door to remove from cabinet.

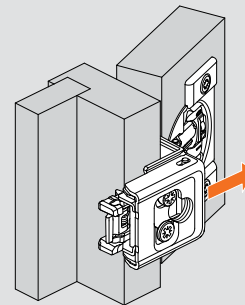

### Cam height adjustment

Not only does the height setting remain unchanged as doors are attached and removed, a cam height adjustment is now available. This allows for the maximum adjustment range without needing to be centered in an elongated hole.

All adjustments now have markings stamped on the hinge near their corresponding screw head.

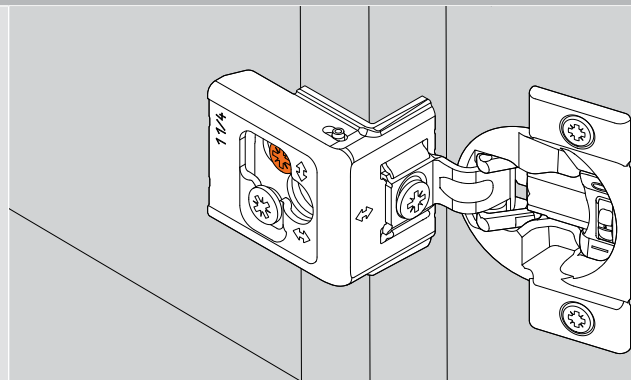

### Pre-mounted screw

The COMPACT CLIP hinge comes with a pre-mounted screw for quick, easy screw head visibility saving time with improved accuracy.

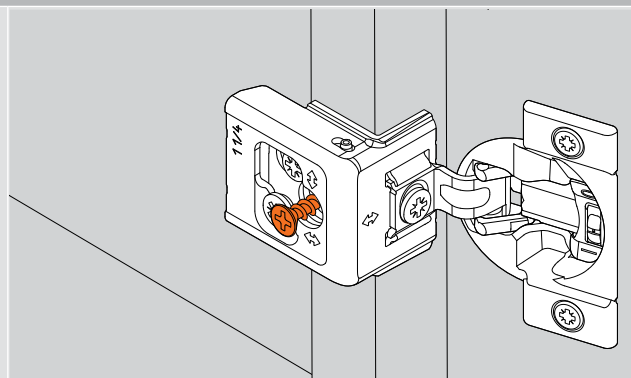



### Three-dimensional cam adjustment

#### Side adjustment

Rotate the front cam screw to increase or decrease door overlay ( $\pm 1/16"$ )

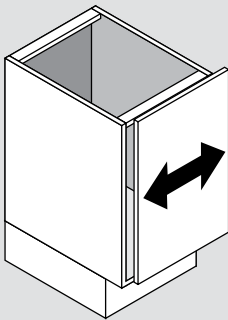
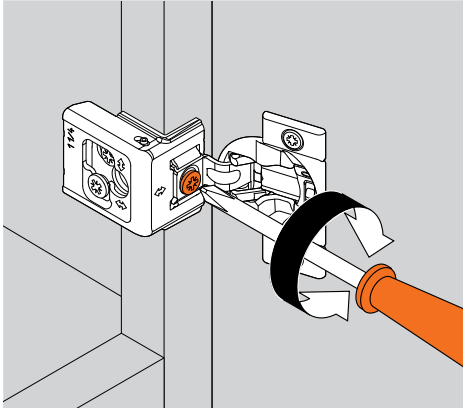

#### Height adjustment

Rotate this cam screw to increase or decrease the height ( $\pm 5/64"$ )

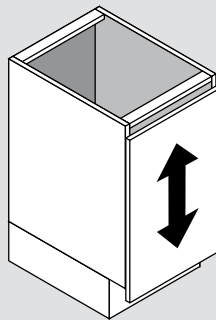
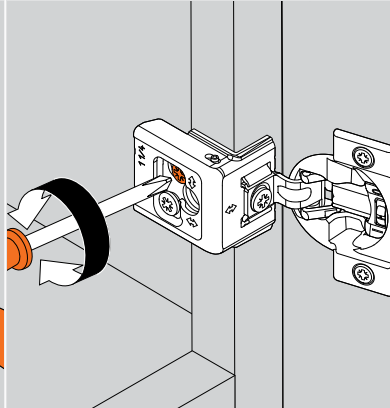

#### Depth adjustment

Rotate this cam screw to adjust door gap ( $+ 3/32"$ ,  $- 1/32"$ )

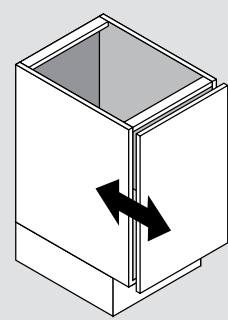
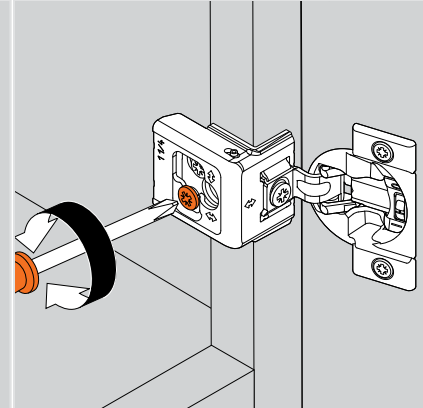

### BLUMOTION Deactivation

#### Deactivation switch on the hinge cup

For small or light doors, the BLUMOTION can be deactivated on one of the hinges. COMPACT CLIP comes in the activated position, marked with a "I". The deactivated position is marked with a "0".

The door must be closed once for the deactivation to be complete. To reactivate, move switch back to the original position "I".

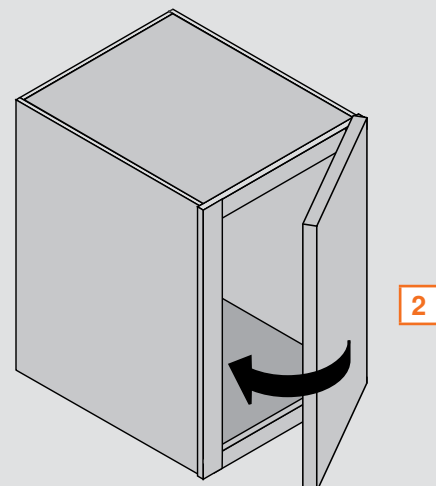
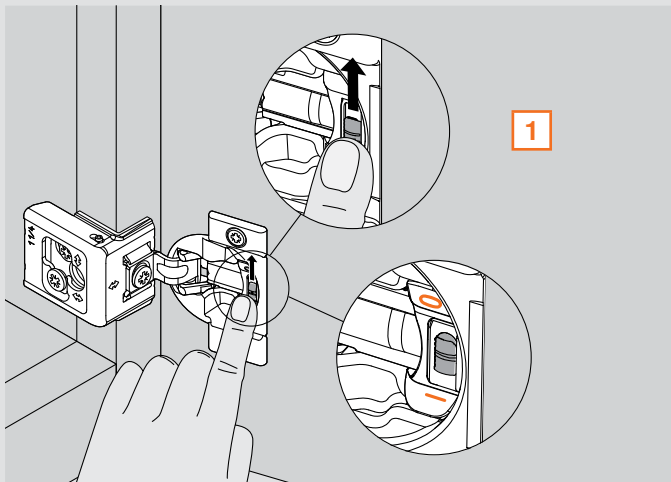



# Hinges



## COMPACT CLIP 30C2 for Partial Overlay

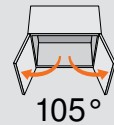

105°

### Features

- Utilizes Blum's CLIP technology
- BLUMOTION integrated into the hinge cup
- Deactivation switch for small/light doors
- Overload safety feature
- Three-dimensional cam adjustment with directional arrows for easy and precise adjustability
- 7/16" cup depth
- Edge mount available in 1/2" overlay
- Pre-mounted wood screw for time-saving and precise installation
- Custom logo cover cap available

### Minimum Reveal

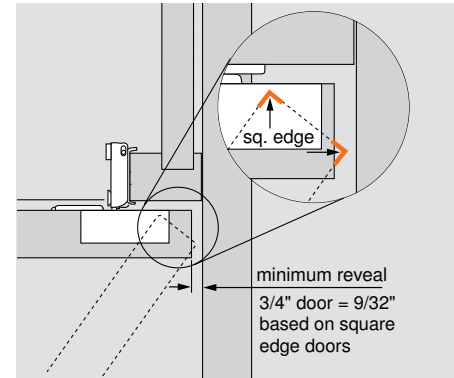

### Boring pattern

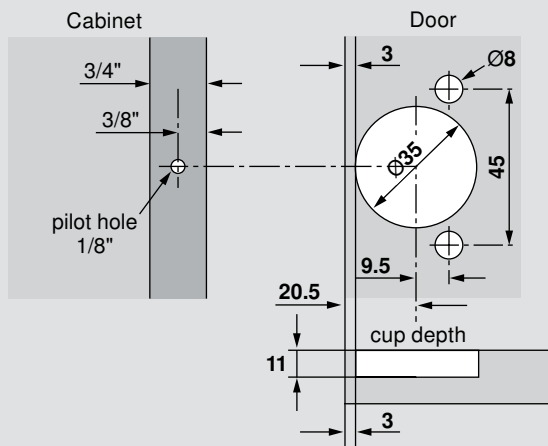

**NOTE:** Maximum door thickness 3/4"

### Adjustments

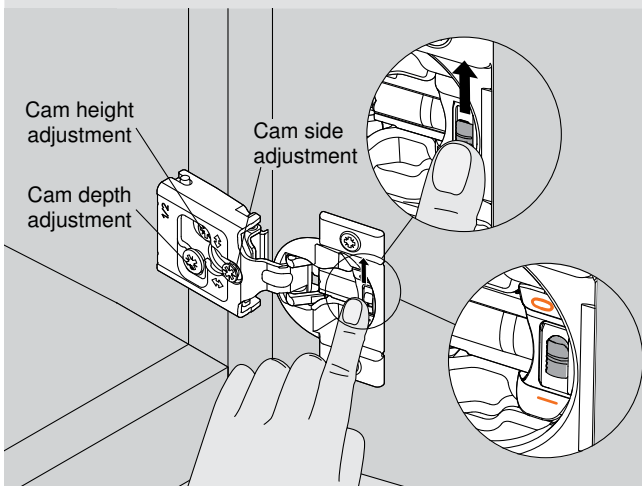

**NOTE:** COMPACT BLUMOTION comes in the activated position, marked with a "1" – the deactivated position is marked with a "0"

### Dimensions

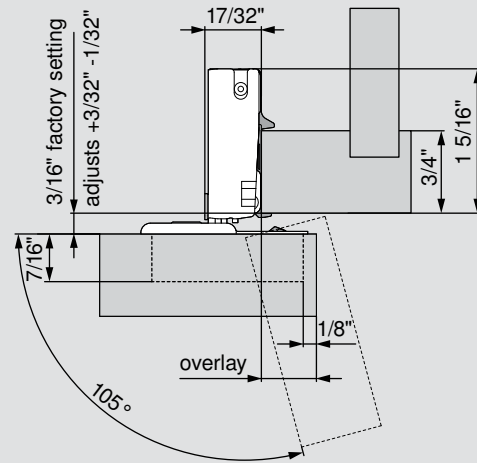

### Wraparound and edge mount hinges

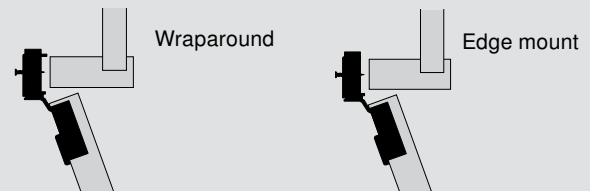

Overlay	Door protrusion	Screw-on	47 Press-in
<b>Wraparound</b>			
5/16"	5/16"		30C258BS05
3/8"	1/4"	30C255BS06	30C258BS06
1/2"	1/8"	30C255BS08	30C258BS08
5/8"	0	30C255BS10	30C258BS10
3/4"	0	30C255BS12	30C258BS12
<b>Edge mount</b>			
1/2"		30C255BSE8	30C258BSE8

### Accessories

Angle restriction clip	38C315B3.1
Hinge cup spacer	38C355B9
*Blank cover cap	30C2508

\*See page 13 for additional cover cap options



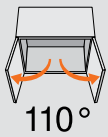

## COMPACT CLIP 31C3 for Full Overlay

## Hinges



### Features

- Utilizes Blum's CLIP technology
- BLUMOTION integrated into the hinge cup
- Deactivation switch for small/light doors
- Overload safety feature
- Three-dimensional cam adjustment with directional arrows for easy and precise adjustability
- 1/2" cup depth
- Less minimum reveal
- Pre-mounted wood screw for time-saving and precise installation
- Custom logo cover cap available

### Minimum Reveal

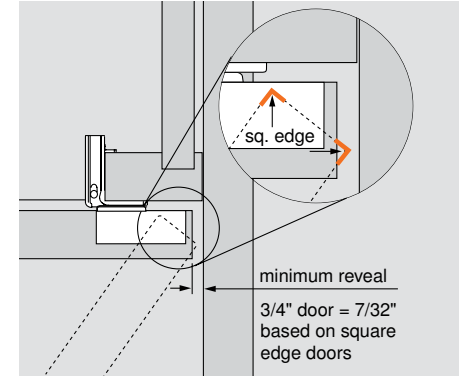

### Boring pattern

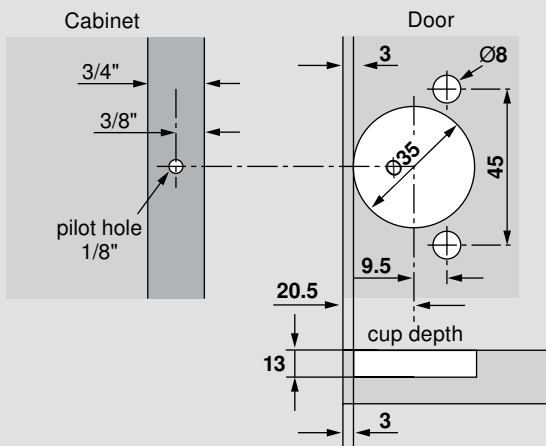

**NOTE:** Maximum door thickness 3/4"

### Dimensions

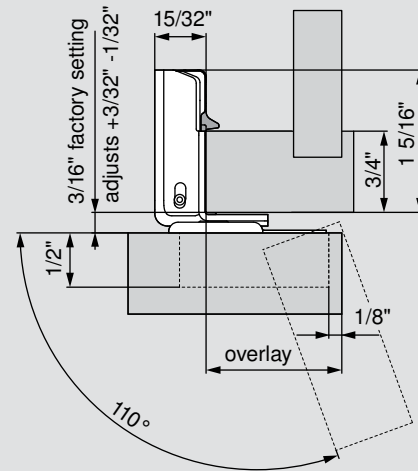

### Adjustments

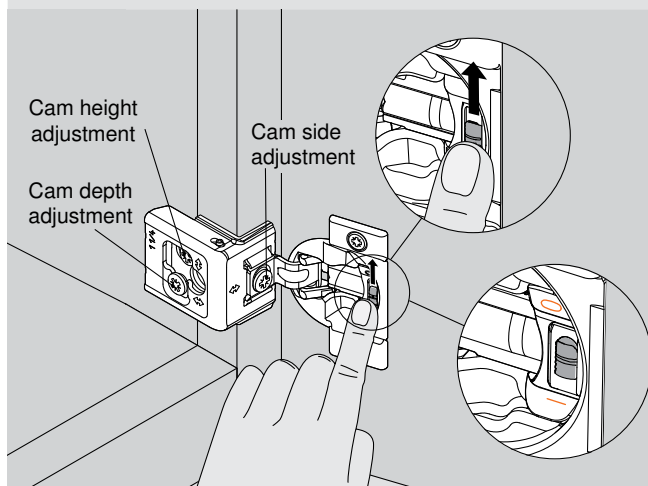

**NOTE:** COMPACT BLUMOTION comes in the activated position, marked with an "I" – the deactivated position is marked with a "0"

### Wraparound hinges

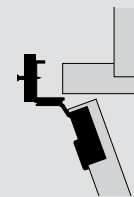

Overlay	Screw-on	47 Press-in
1"	31C355BS16	31C358BS16
1-1/4"	31C355BS20	31C358BS20
1-5/16"	31C355BS21	31C358BS21
1-3/8"	31C355BS22	31C358BS22
1-1/2"	31C355BS24	31C358BS24
1-9/16"		31C358BS25

### Accessories

Angle restriction clip	38C315B3.1
Hinge cup spacer	38C355B9
*Blank cover cap	31C1508

\*See page 13 for additional cover cap options



# Hinges



## COMPACT CLIP 31C1 for Full Overlay

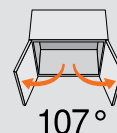

### Features

- Utilizes Blum's CLIP technology
- BLUMOTION integrated into the hinge cup
- Deactivation switch for small/light doors
- Overload safety feature
- Three-dimensional cam adjustment with directional arrows for easy and precise adjustability
- 7/16" cup depth
- Ideal for profiled doors
- Pre-mounted wood screw for time-saving and precise installation
- Custom logo cover cap available

### Minimum Reveal

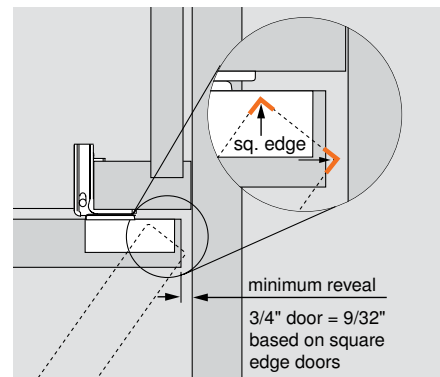

### Boring pattern

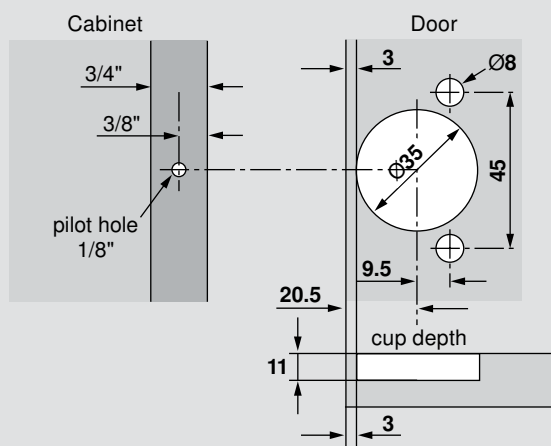

**NOTE:** Maximum door thickness 3/4"

### Dimensions

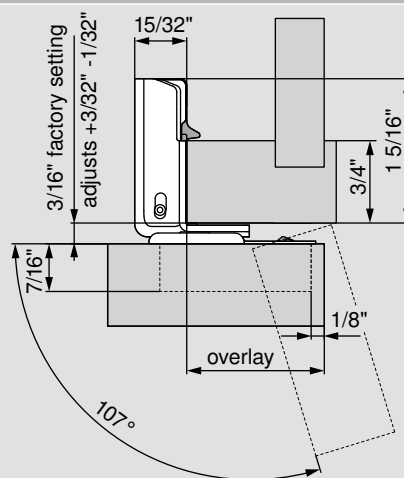

### Adjustments

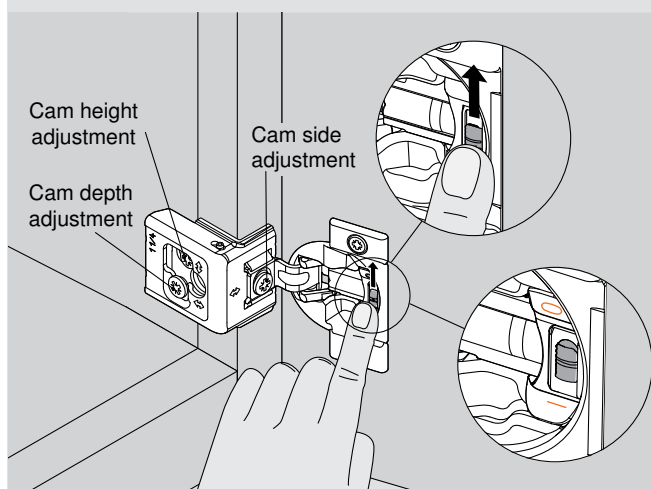

**NOTE:** COMPACT BLUMOTION comes in the activated position, marked with an "I" – the deactivated position is marked with a "0"

### Wraparound hinges

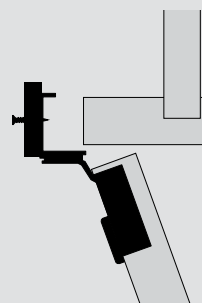

Overlay	Screw-on	47 Press-in
1-1/4"		31C158BS20

### Accessories

Angle restriction clip	38C315B3.1
Hinge cup spacer	38C355B9
*Blank cover cap	31C1508

\*See page 13 for additional cover cap options



### Hinge arm cover caps

	<ul style="list-style-type: none"> <li>Nylon, deep gray cap</li> <li>Available blank or printed (Blum logo)</li> <li>Also available with printed custom logo (minimum order quantity applies)</li> </ul>	Part no.
	30C blank cover cap	30C2508
	30C Blum logo printed cover cap	30C2508.BL
	31C blank cover cap	31C1508
	31C Blum logo printed cover cap	31C1508.BL

### Angle restriction clip

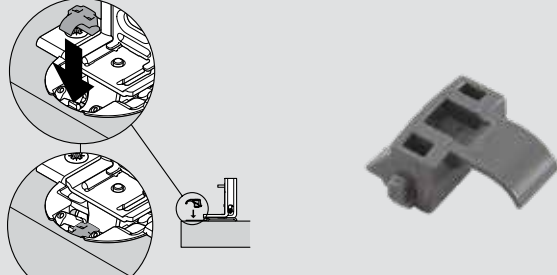
	<ul style="list-style-type: none"> <li>Restricts opening angle of the COMPACT CLIP to 86°</li> <li>Angle restriction clip must be inserted before the hinge has been attached to the face frame</li> <li>Gray nylon</li> </ul>	Part no.
	Angle restriction clip	38C315B3.1

### Hinge cup spacer

	<ul style="list-style-type: none"> <li>1/16" spacer for use under the hinge cup for thin or profile doors</li> <li>Non-stackable</li> <li>Gray nylon</li> </ul>	Part no.
	Hinge cup spacer	38C355B9

### Angle restriction clip

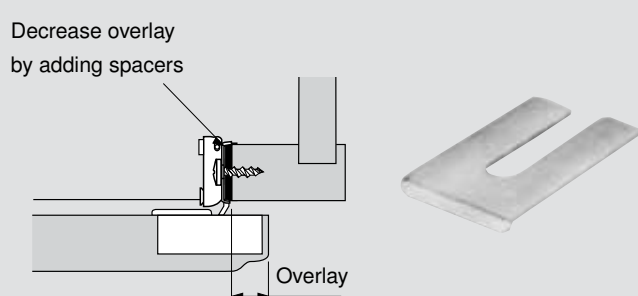
	<ul style="list-style-type: none"> <li>Steel spacer decreases door overlay in 1/32" increments</li> <li>Can be stacked to achieve desired overlay reduction</li> <li>Steel, zinc-coated</li> </ul>	Part no.
	Distance spacer	36.3515



## Hinges



## COMPACT CLIP Hinge Accessories

### POZI DRIVER and bits

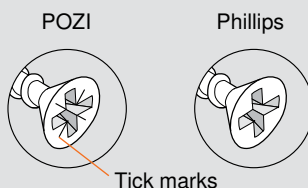

A POZI screwdriver (different from Phillips) is the most crucial tool you can use to assure that full torque is applied to all Blum adjustment screws. POZI screws can be identified by the distinctive "tick" marks located in the center of the screw head recess.

Part no.

#2 POZI DRIVER	<b>POZI DRIVER</b>
1/4" Magnetic bit holder	<b>BIT HOLDER</b>
#2 x 1" POZI bit insert	<b>POZI BIT #2X1</b>
#2 x 2" POZI bit insert	<b>POZI BIT #2X2</b>

### Deep thread wood screws for frame attachment

- Replacement screw for attaching hinge

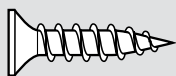

Part no.

#8 x 3/4 Phillips flat head -Type 17,  
self cutting point

**66R.190**

### Ø8 mm dowels

- Square head dowel for attaching to hinges

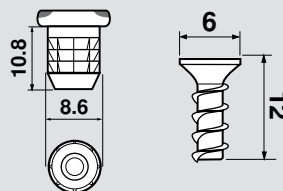

Part no.

Ø8 mm dowel

**30C2582**

Installation screw

**60A.122**

### Deep thread wood screws

- For attaching hinges and mounting plates



Part no.

#6 x 5/8", #2 Phillips

**606N**

#6 x 5/8", #2 POZI

**606P**